



**JH INDUSTRIES, INC.**

**The "SEL" Series  
Edge of Dock**

# JH INDUSTRIES, INC.

- JH Industries has been manufacturing the Copperloy brand Edge-of-Dock Leveler (EOD) for over 15 years.
- Our original model was the “SED” series, also referred to as the CAM model.
- Striving for continuous improvement, we replaced the “SED” and launched the “SET” series in 2000.
- The SET design proved to be more durable, and opened the door for “automation” in the manufacturing of the EOD line.
- BUT...there is always room for further improvements!



# The New SEL Series

## Edge-of-Dock Leveler



# The "SEL" Series Improvements

The linkage weldments have been redesigned for strength, and to reduce the risk of truck impact with vital components.

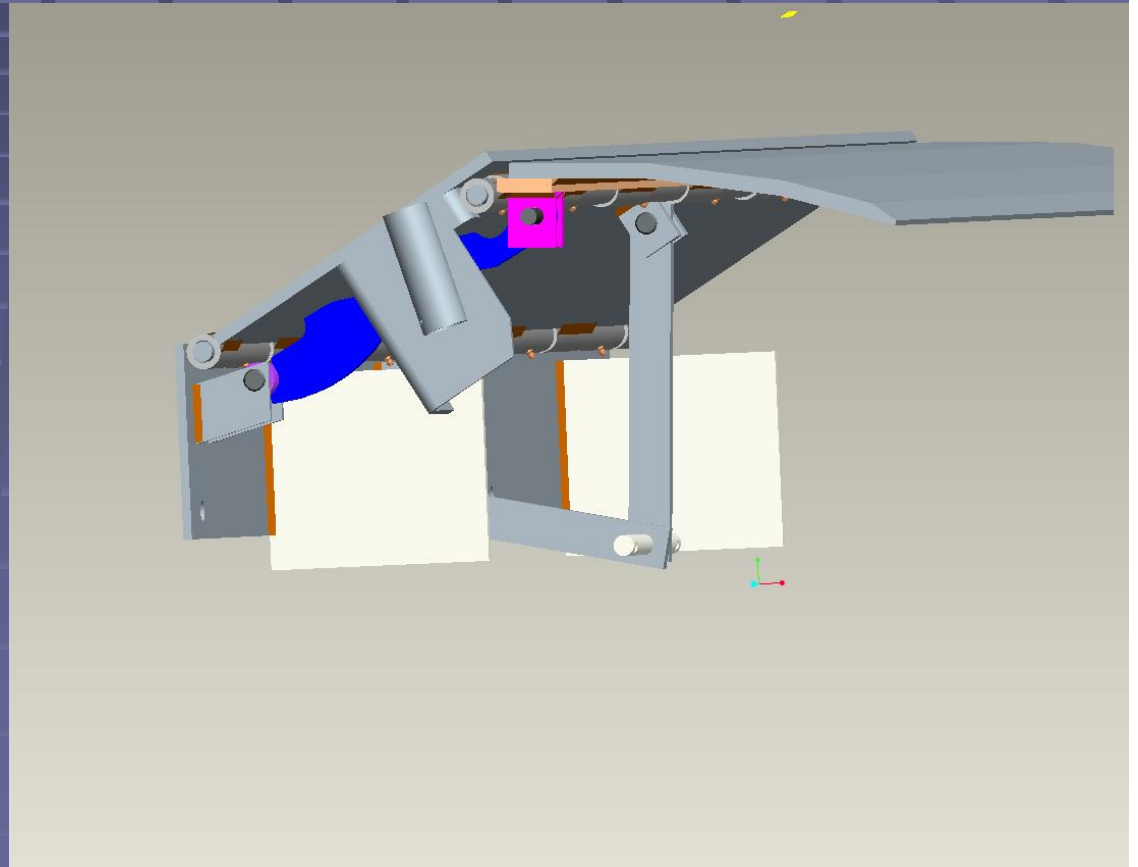

# The "SEL" Series Improvements

The new linkage bar is designed to automatically "kick-out" once the lip has been set in place. This reduces the amount of wear on both the linkage bar as well as the roller pin assembly.

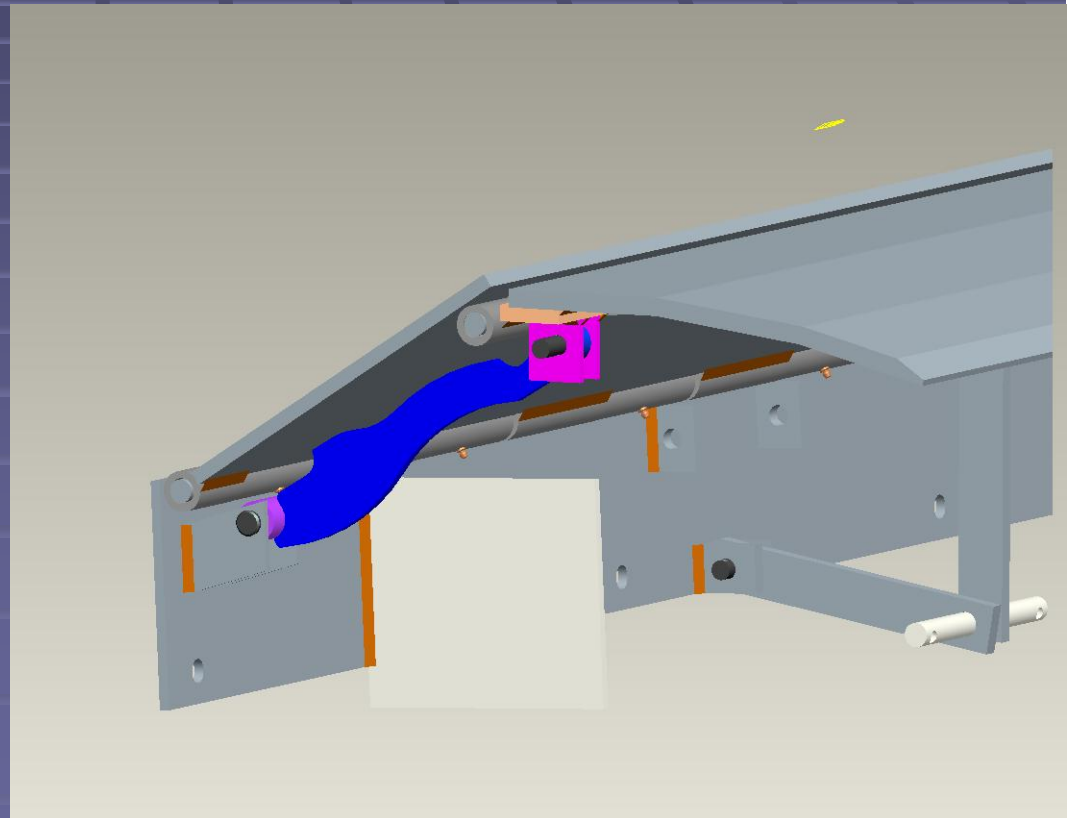

# The "SEL" Series Improvements

The new weldment design allows for greater weld penetration on the hinge support, creating a stronger unit.

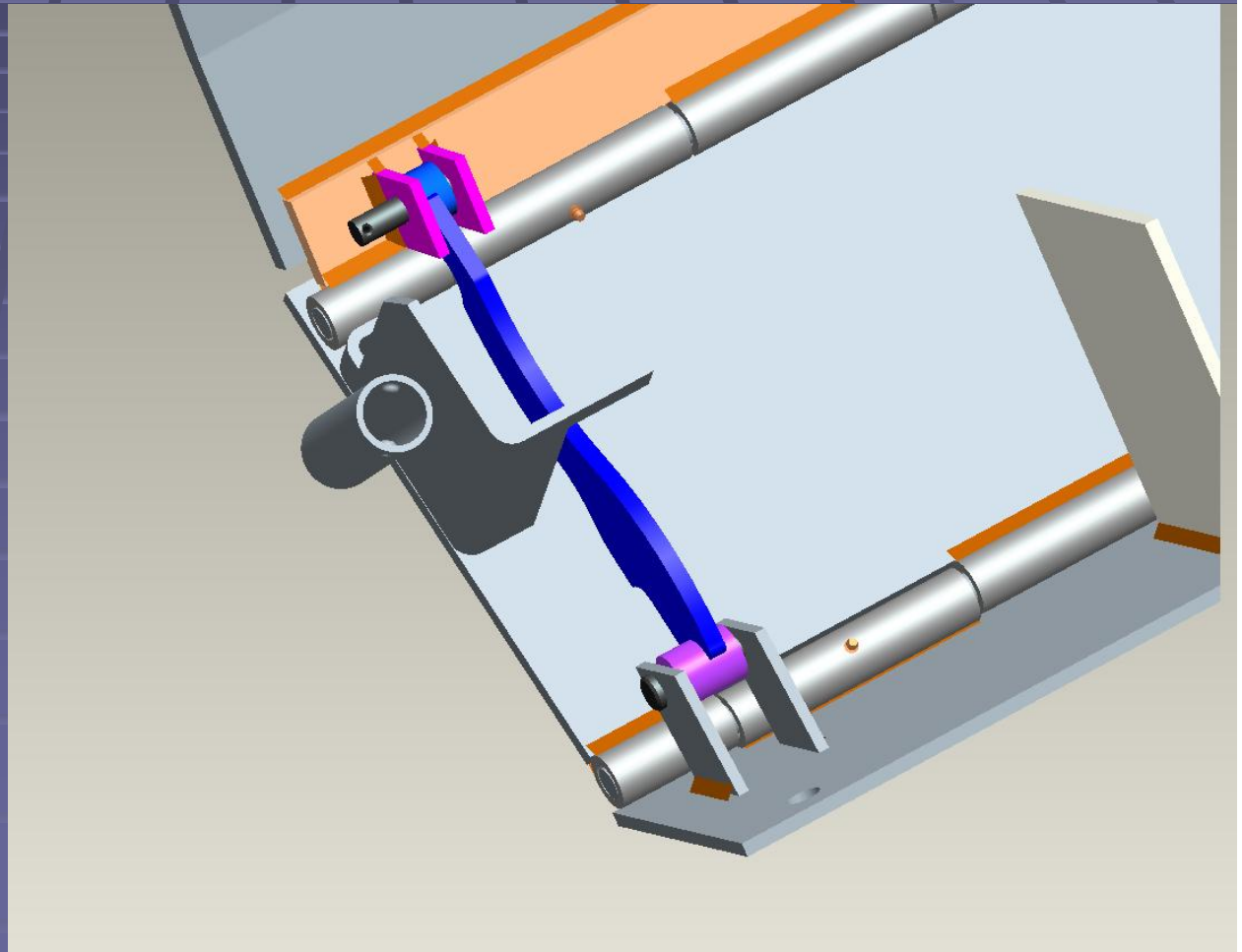

# The "SEL" Series Improvements

New "lubed for life" bushings reduce the wear on the roller and linkage bar pin, eliminating the need for routine maintenance of these parts.

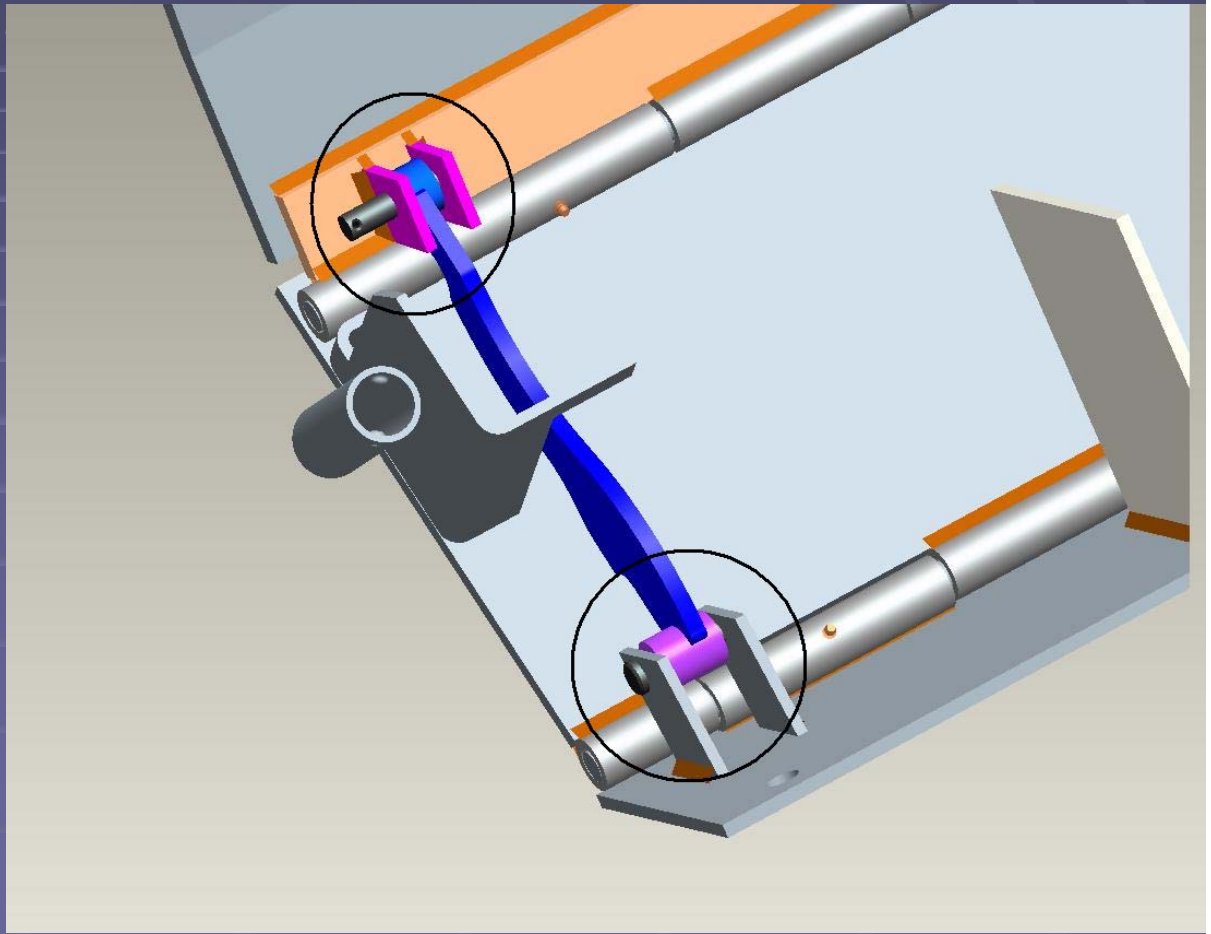

# The “SEL” Series Improvements

To decrease the potential loss of load resulting from hinge spool bumps, we have re-positioned the hinge tube to be flush with the loading dock surface.

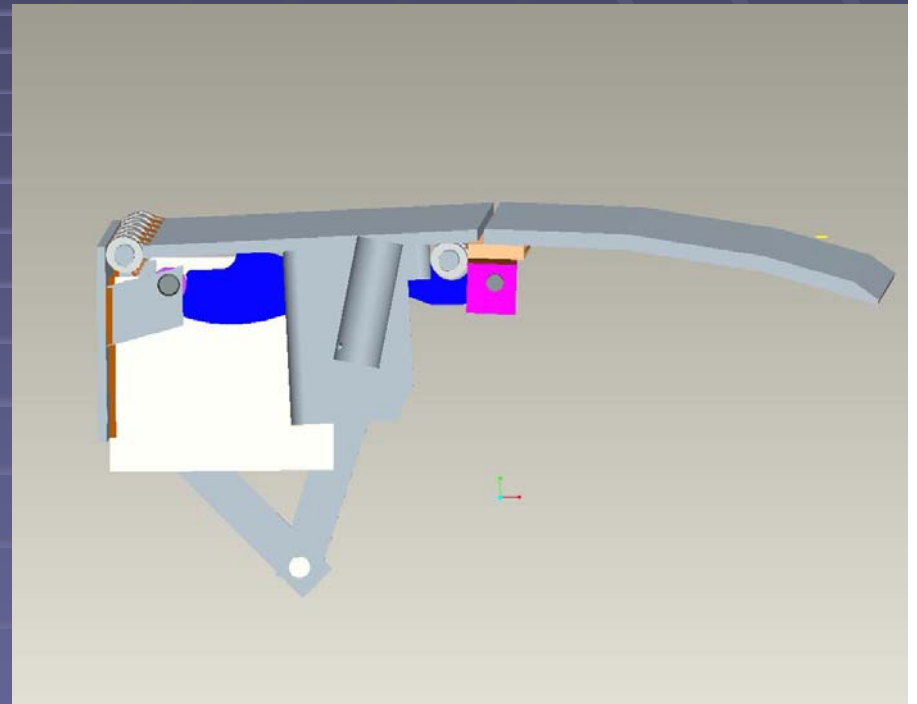

# The "SEL" Series Improvements

Without affecting the height differential, we have reduced the degree of bend in our lip plate for a smoother transition during loading and unloading.

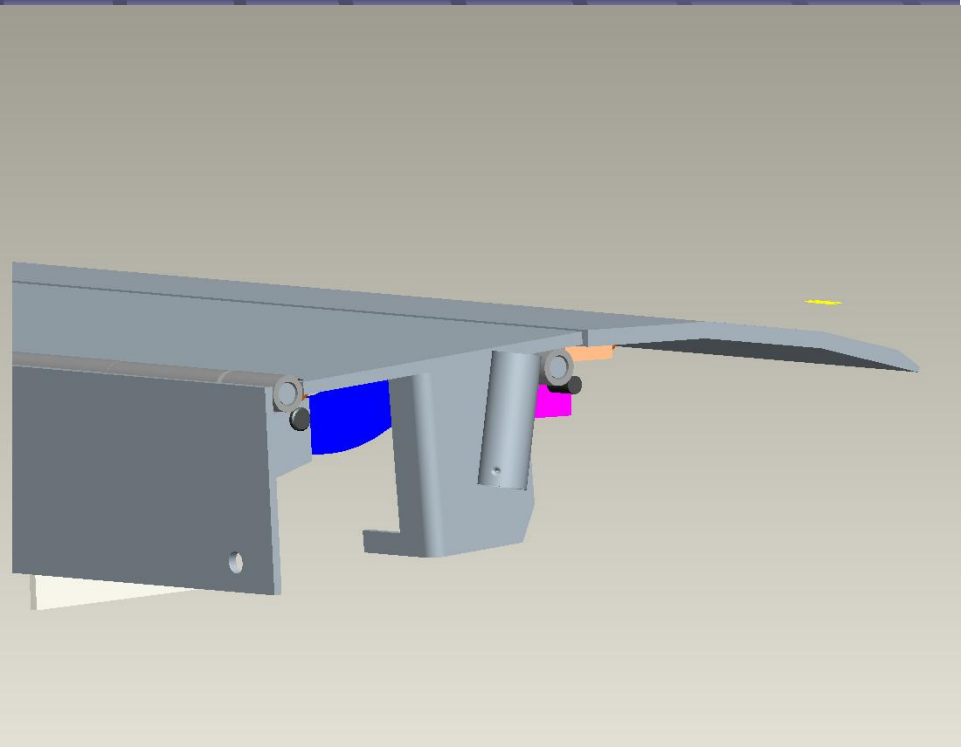

# The "SEL" Series Improvements

The hinge tube assembly has been set back  $3/16$ " further on the ramp plate. By doing this, we have virtually eliminated the "gap" between the lip and ramp plate while in the extended position. This change has substantially increased the overall strength and durability of our EOD.

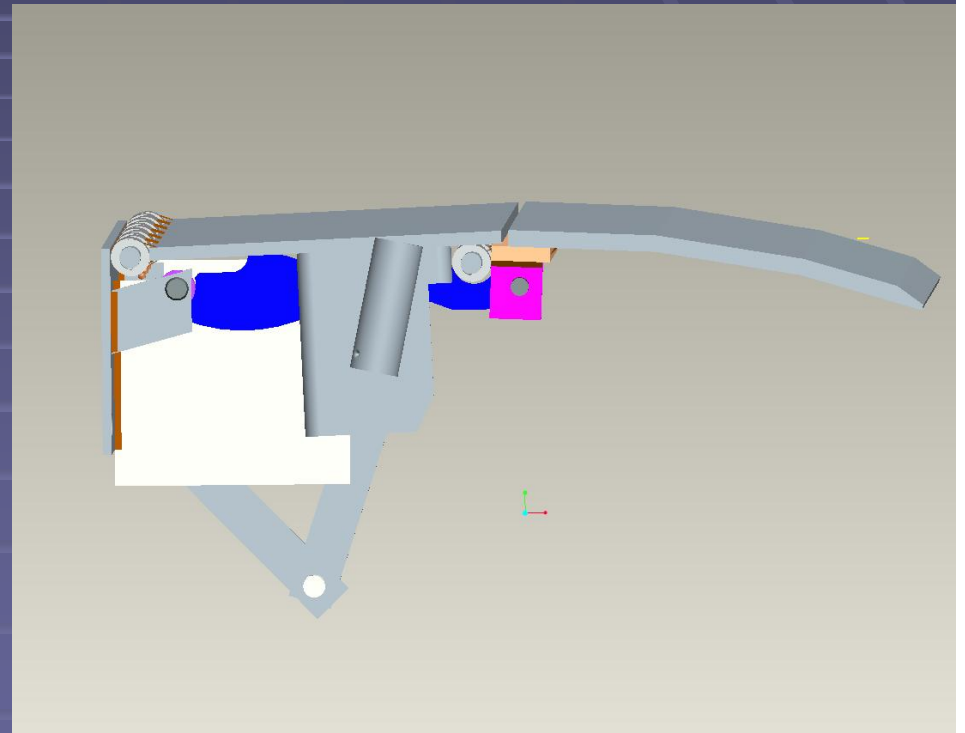

# **The “SEL” Series Improvements**

**Another significant improvement is the reduced amount of handle travel and force required to activate the EOD.**

*Copperloy*

